

# WAGNER®

PAINT FAST. PAINT SMART.

# 4-Speed WIDESHOT® POWER PAINTER®

Owner's manual: Read this manual for complete instructions

Featuring

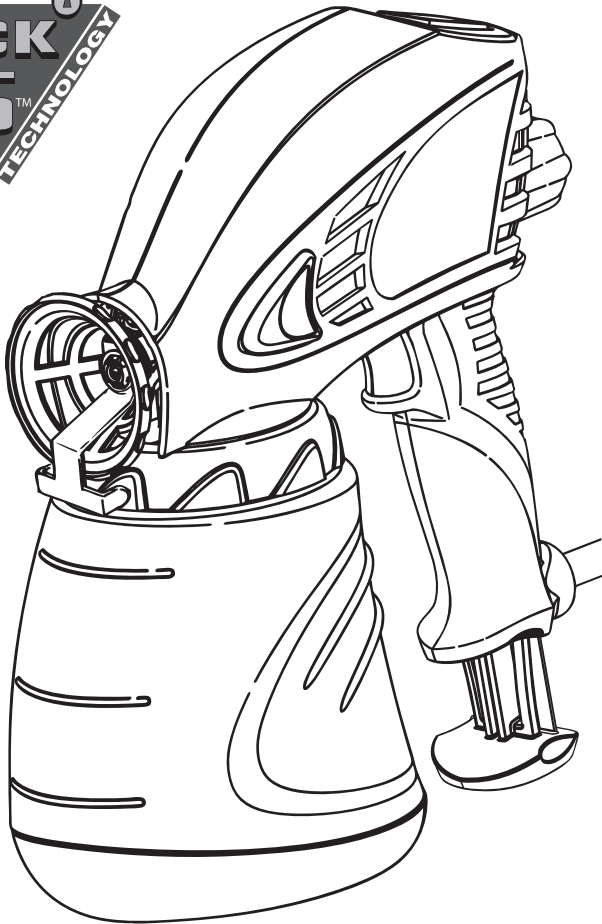

## Table of Contents

Safety Information	2-3
Parts and Components	3
Before You Begin	4
Fluid Container Setup	5
Suction Extension Setup	6
Backpack Kit Setup	7
Speed Control	8
Flow Control Knob	8
Testing the Spray Pattern	9
Priming with the Suction Extension	10
Overspray	10
How to Spray	11
Using the quick-clean feature (fluid container)	12
Using the quick-clean feature (suction extension)	13
Cleanup for oil-based materials (fluid container)	14
Cleanup for oil-based materials (suction extension)	15
Cleaning the Components / Reassembly	16
Maintenance	17
Replacement Parts	17
Troubleshooting	18
<b>Français</b>	<b>19</b>
<b>Español</b>	<b>37</b>
Parts List	55
Warranty	56



**1-800-328-8251**

**Wagner Technical Service**

Visit us on the world wide web!

<http://www.wagnerspraytech.com>

1770 Fernbrook Lane, Plymouth, MN 55447

**Need Help? Call us first for answers fast.** Call Wagner Spray Tech toll-free if you have any comments or problems with this product.

**Technical service hours: Monday through Friday, 8:00 am to 4:30 pm Central Time**



# Important Safety Information • Read all safety information before operating the equipment. Save these instructions

To reduce the risks of fire or explosion, electrical shock and the injury to persons, read and understand all instructions included in this manual. Be familiar with the controls and proper usage of the equipment.

## HAZARD: INJECTION INJURY

A high pressure stream of paint produced by this equipment can pierce the skin and underlying tissues, leading to serious injury and possible amputation.



**DO NOT TREAT AN INJECTION INJURY AS A SIMPLE CUT! Injection can lead to amputation. See a physician immediately.**

### NOTE TO PHYSICIAN:

**Injection into the skin is a traumatic injury. It is important to treat the injury surgically as soon as possible. DO NOT delay treatment to research toxicity. Toxicity is a concern with some coatings injected directly into the blood stream. Consultation with a plastic surgeon or reconstructive hand surgeon may be advisable.**

### PREVENTION:

- NEVER aim the gun at any part of the body.
- Do not aim the gun at, or spray any person or animal.
- NEVER allow any part of the body to come in contact with the fluid stream.
- NEVER put your hand in front of the gun. Wear gloves. Gloves will not provide protection against an injection injury.
- Keep hands and other body parts away from the discharge. For example, do not try to stop leaks with any part of the body.
- Always unplug the spray gun before servicing, cleaning tip guard, changing tips, or leaving unattended.
- ALWAYS use the nozzle tip guard. Do not spray without nozzle tip guard in place. The tip guard provides some protection against injection injuries but is mainly a warning device. Only use a nozzle tip specified by Wagner.

## HAZARD: EXPLOSION OR FIRE

Solvent and paint fumes can explode or ignite, causing property damage and/or severe injury.



### PREVENTION:

- Exhaust and fresh air introduction must be provided to keep the air within the spray area free from accumulation of flammable vapors.
- Avoid all ignition sources such as static electricity sparks, open flames, pilot lights, hot objects, cigarettes, and sparks from connecting and disconnecting power cords or working light switches.
- Fire extinguishing equipment must be present and in good working order.
- Follow the material and solvent manufacturer's safety precautions and warnings.
- Do not spray flammable or combustible materials near an open flame or sources of ignition such as cigarettes, motors, and electrical equipment.
- Know the contents of the paints and solvents being sprayed. Read all Material Safety Data Sheets (MSDS) and container labels provided with the paints and solvents. Follow the paint and solvent manufacturer's safety instructions.



## HAZARD: EXPLOSION HAZARD DUE TO INCOMPATIBLE MATERIALS

Will cause property damage or severe injury.

### PREVENTION:

- Do not use bleach.
- Do not use halogenated hydrocarbon solvents such as methylene chloride and 1,1,1 - trichloroethane. They are not compatible with aluminum and may cause an explosion. If you are unsure of a material's compatibility with aluminum, contact your coating supplier.



## HAZARD: HAZARDOUS VAPORS

Paints, solvents, insecticides, and other materials can be harmful if inhaled or come in contact with the body. Vapors can cause severe nausea, fainting, or poisoning.



### PREVENTION:

- Use a respirator or mask if vapors can be inhaled. Read all instructions supplied with the mask to be sure it will provide the necessary protection.
- Wear protective eyewear.
- Wear protective clothing as required by coating manufacturer.



## HAZARD: GENERAL

Can cause severe injury or property damage.

### PREVENTION:

- Read all instructions and safety precautions for equipment and spray material before operating any equipment.
- Comply with all appropriate local, state, and national codes governing ventilation, fire prevention, and operation.
- Keep sprayer out of the reach of children.
- Hearing protection is recommended for extended use.
- Always wear appropriate gloves, eye protection and a respirator or mask when painting.
- Do not operate or spray near children. Keep children away from equipment at all times.
- Do not overreach or stand on an unstable support. Keep effective footing and balance at all times.
- Stay alert and watch what you are doing.
- Do not operate the unit when fatigued or under the influence of drugs or alcohol.

## HAZARD: ELECTRIC SHOCK HAZARD

May cause severe injury.



### PREVENTION:

- Keep electrical cord plug and spray gun trigger free from paint and other liquids. Never hold cord at plug connections to support cord. Failure to observe may result in an electrical shock.
- Never immerse electrical parts in water or any other liquid. Wipe the exterior of the sprayer with a damp cloth for cleaning. Always make sure the sprayer is unplugged before taking it apart for cleaning.

**NOTE - Use only a 3-wire extension cord that has a 3-blade grounding plug and a 3-slot receptacle that will accept the plug on the product. Make sure your extension cord is in good condition. When using an extension cord, be sure to use one heavy enough to carry the current your product will draw. For lengths less than 50 feet, use a No. 18 AWG extension cord. For lengths more than 50 feet, use a No. 14 or No. 16 AWG extension cord. An undersized cord will cause a drop in line voltage resulting in loss of power and overheating.**

Wagner Spray Tech accessory extension cords recommended:

- P/N 0090241 20 foot extension cord
- P/N 0090242 35 foot extension cord

Minimum gauge for extension cords									
Ampere rating range	Voltage	Cord length (feet)							
		25-50	100	150	200	250	300	400	500
2 - 3	120V	18	16	14	14	12	12	10	10



# Important Safety Information • Read all safety information before operating the equipment. Save these instructions

## Grounding Instructions

This product must be grounded. In the event of an electrical short circuit, grounding reduces the risk of electric shock by providing an escape wire for the electric current. This product is equipped with a cord having a grounding wire with an appropriate grounding plug. The plug must be plugged into an outlet that is properly installed and grounded in accordance with all local codes and ordinances.

### ⚠WARNING

**Danger! Improper installation of the grounding plug can result in a risk of electric shock.**

If repair or replacement of the cord or plug is necessary, do not connect the green grounding wire to either flat blade terminal. The wire with insulation having a green outer surface with or without yellow stripes is the grounding wire and must be connected to the grounding pin.

Check with a qualified electrician or serviceman if the grounding instructions are not completely understood, or if you are in doubt as to whether the product is properly grounded. Do not modify the plug provided. If the plug will not fit the outlet, have the proper outlet installed by a qualified electrician.

This product is for use on a nominal 120 volt circuit and has a grounding plug that looks like the plug illustrated below. Make sure that the product is connected to an outlet having the same configuration as the plug. **No adapter should be used with this product.**

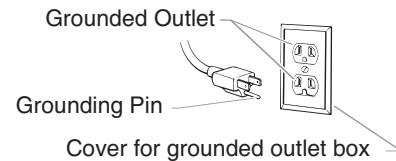

## Parts and Components

- a) Sprayer assembly
- b) Lock-N-Go™ release buttons
- c) Spray tip
- d) 1 1/2 quart fluid container
- e) Speed control switch
- f) Flow control knob
- g) Trigger
- h) Pump housing assembly
  - 1) Piston
  - 2) Spring
  - 3) Pump housing
  - 4) Pump housing ring
  - 5) Swirl valve (2)
- i) Extendable handle\*
- j) Suction set
- k) Dual hose set
- l) Dual hose fitting
- m) Container clip
- n) Quick-clean cap
- o) Cleaning brush
- p) Cleaner / Lubricant\*\*
- q) Back pack kit

\*\*included in some models

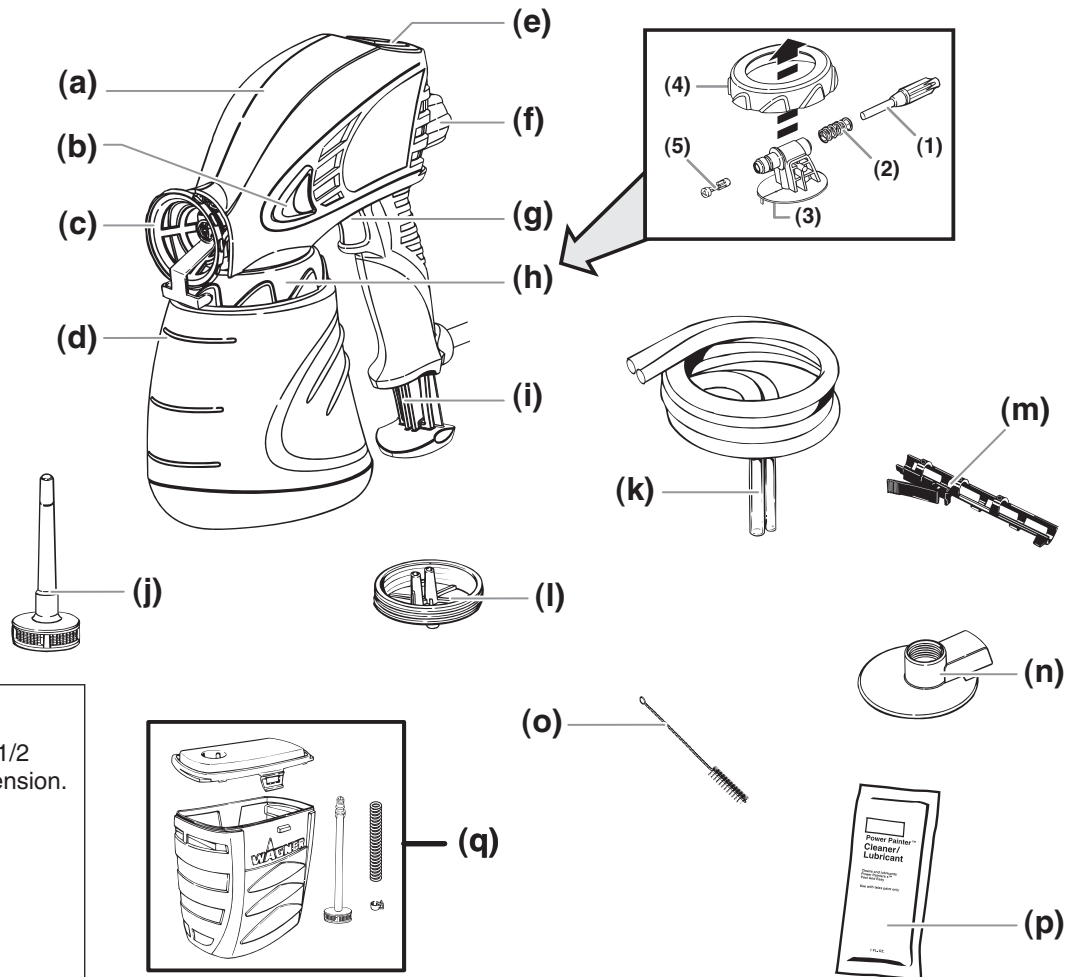

### \*Extendable Handle

When you are using the larger, 1 1/2 quart cup, pull out the handle extension.

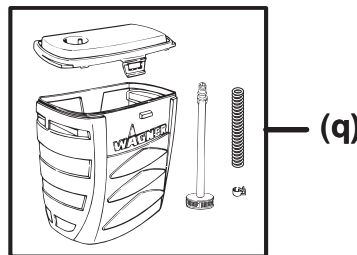

# Important - Before You Begin

## Selecting the Proper Tip:

It is important that you use the proper spray tip based on your type of spraying job and the type of material you plan to spray. Read below for details.

### Wide Angle Tip (Wide Shot™)

The wide angle tip produces a wide pattern that can be adjusted horizontally or vertically.

#### To adjust:

1. Make sure the sprayer is unplugged. Loosen the wide angle tip by turning the tip **counterclockwise** 1/4 turn.
2. Turn the adjusting arm so that it is pointing down for a horizontal pattern **(a)**. Turn the adjusting arm so that it is pointing to the side for a vertical pattern **(b)**.

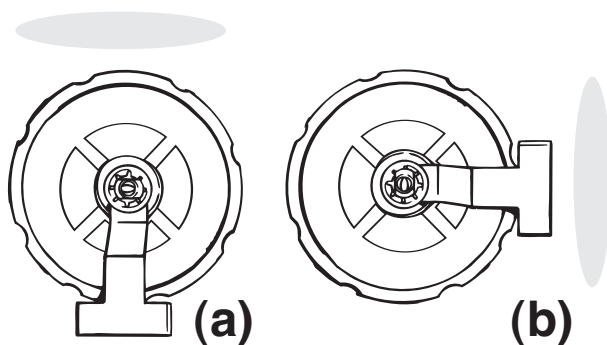

3. Tighten the tip firmly by hand.

### Round Tip

The round tip produces a round pattern. Use a round tip if the surface you are spraying is too small for use with the wide angle tip. A round tip is an option included with some models and is available at your local retailer. Use the size that works best for the type of material you are spraying. The color of the tip center indicates its size:

1. **Blue (light materials)** - .023 inch (0.6mm) opening. This size works best for oil-based materials.
2. **Pink (medium materials)** - .031 inch (0.8mm) opening. This all purpose size works best for latex materials.
3. **Green (heavy materials)** - .039 inch (1.0mm) opening. This size works best for hard to spray, coarse materials such as thick latex.

### Stain Tip

The stain tip is an option included with some models. It has a specially designed opening for use with thin materials such as thin stains, sealers and waterproofers, and can be adjusted to reduce overspray. If you did not receive a stain tip and will be spraying one of these materials, the tip can be purchased at your local retailer.

The stain tip pattern is round with a fine spray. To adjust the spray pattern size and coarseness, turn the tip slightly counterclockwise to narrow the pattern and make the spray more coarse. Turn the tip slightly clockwise to widen the pattern and make the spray more fine.

**IMPORTANT** - Make sure to tighten all spray tips firmly by hand. If the spray tip is not tightened firmly enough, the sprayer could leak or the tip could be damaged. Do not use a tool to tighten the spray tip. If the tip is too tight, it may be damaged.

## Important Preparation Tips:

- It is important to mix the material thoroughly before you begin. Do not shake the material to mix it. Always stir the material gently but thoroughly before use.
- Remove any skin that has formed on the top of the material. Do not mix the skin into the material. The skin can break up and clog the sprayer. Older paint may need to be strained.
- The swirl valve that comes with your sprayer has a clear base. It is to be used with latex and oil-based paints only.
- If you will be spraying lacquers, make sure to use the optional swirl valve designed for lacquers, available for purchase by calling our toll free number. It has a gray base (look in [Accessories](#) for part number).

# Fluid Container Setup

1. Press the Lock-N-Go™ buttons on both sides of the sprayer with one hand, grab the cup with your other hand, and slide the spray cartridge out.

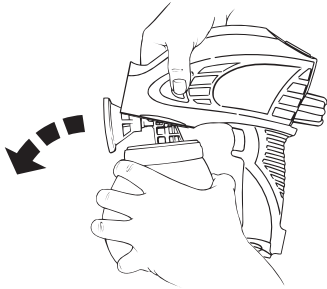

2. Remove the material container from the pump housing by turning the pump housing locking ring **counterclockwise**.

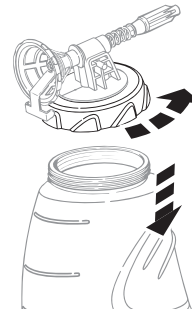

3. Fill the container with the material to be used.



4. Place a few drops of household oil down the intake (a) and return openings (b) in the pump housing.

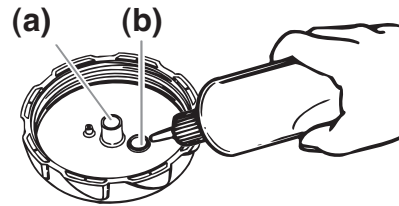

5. Insert the suction set into the intake opening.

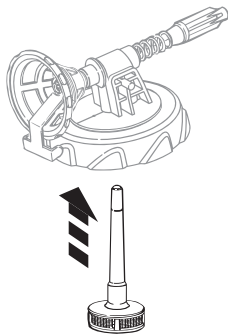

6. Line up the tab (c) on the pump housing with the notch (d) on the material container. Twist the pump ring to thread the cup onto the pump. Plug in the sprayer.

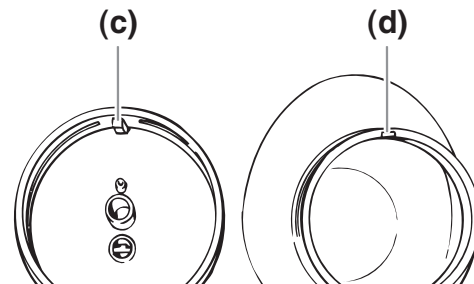

7. Take cartridge and slide the rear of the piston into the spray gun. Make sure the pegs (e) on the cartridge line up with the guides (f) at the bottom of the sprayer. Press cartridge up until it locks into place.

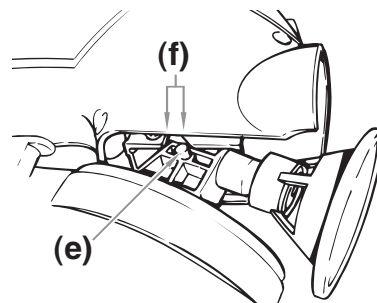
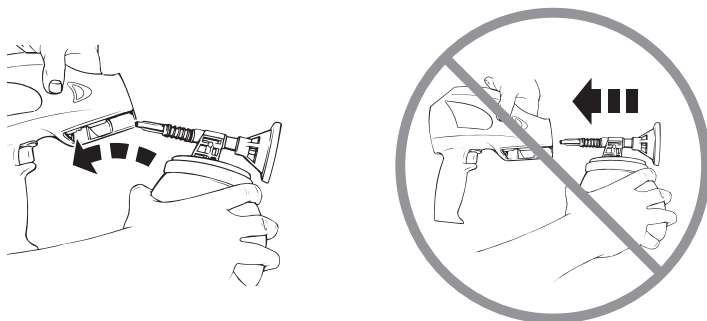



# Suction Extension Setup (optional)

1. Unplug the sprayer. Press the Lock-N-Go™ buttons on both sides of the sprayer with one hand, grab the pump with your other hand, and slide the cartridge out.

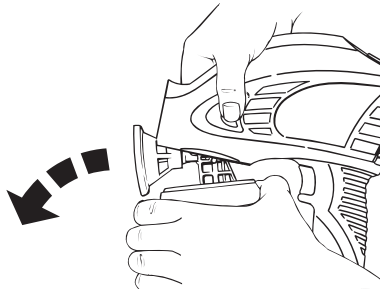

2. Remove the material container from the pump housing by turning the pump housing locking ring **counterclockwise**.



3. Place a few drops of household oil down the intake (a) and return openings (b) in the pump housing.

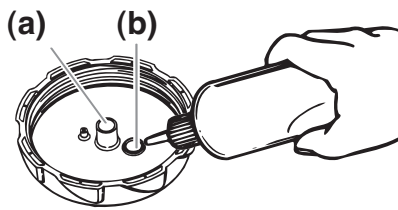

4. Push the dual hose fitting (c) into the intake and return openings on the bottom of the pump housing. The fitting with the ridge (d) goes into the return opening. Twist the pump housing ring (e) **clockwise** to tighten the dual hose fitting into place.

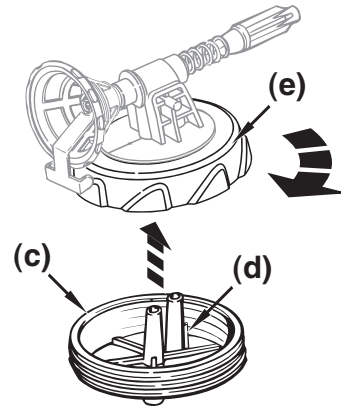

5. Take cartridge and slide the rear of the piston into the spray gun. Make sure the pegs (f) on the cartridge line up with the guides (g) at the bottom of the sprayer. Press cartridge up until it locks into place.

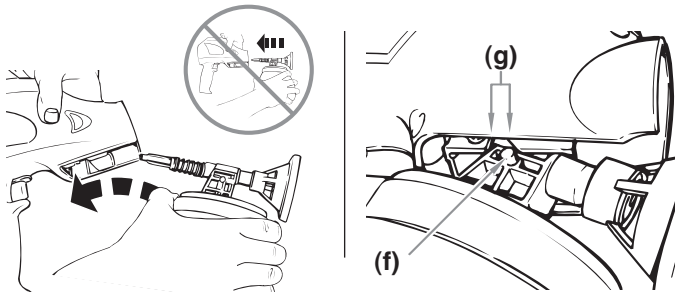

6. Push the suction hose set onto the intake and return ports of the dual hose fitting. The larger hose (h) goes onto the intake (i) port.

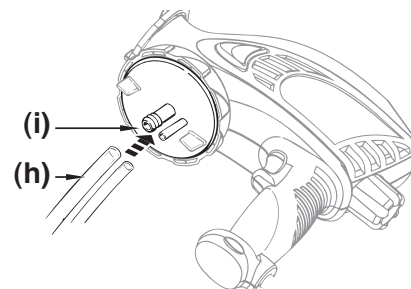

7. Slide the intake hose [(j), the larger hose] through the container clip (k). You may need to pull the hoses slightly apart.

Push the intake hose onto the suction set assembly so that it is flush with the ridge (l). Make certain that the intake filter (m) is in place on the suction set.

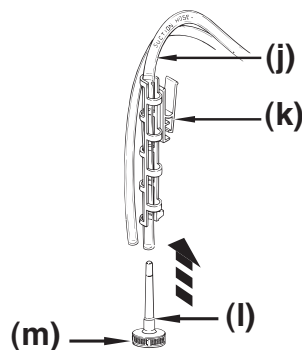

8. Submerge the suction set assembly into the material container and attach the container clip (n) to the side to hold it securely. Make certain that the return line (o) is inside the container.

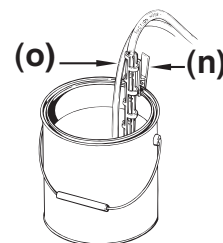

# Backpack Kit Setup (optional)

1. Lay cord seal (a) in backpack lid groove (b). Overlap the ends of the cord seal by approximately 1/2 inch. Cut off remaining seal. Lift seal and butt edges together and press excess seal into groove.

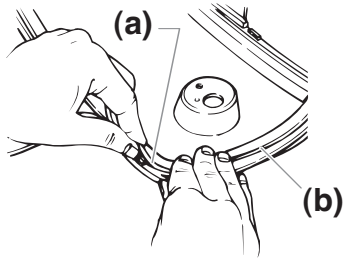

2. Snap suction tube (c) through hole in bottom of backpack lid. Assemble backpack kit as shown and secure clip onto suction hose (d). When backpack kit is assembled, follow steps 1-6 in **Suction Extension Setup** (previous page) to attach the kit to the sprayer.

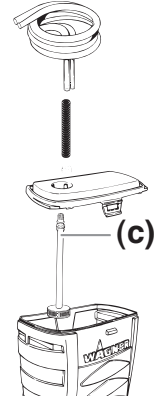
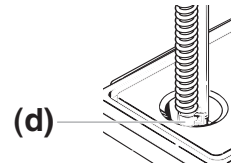

3. Assemble strap hooks to container using same hole as lid clip. Adjust strap to fit user.

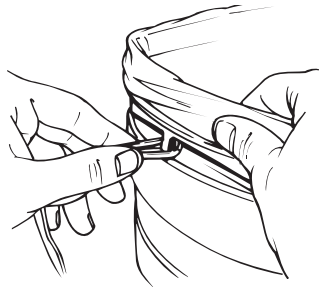

4. If you want to use a backpack liner, install as shown.



5. Pour material into back pack to fill line. **Do not fill above the indicated fill line (e).**

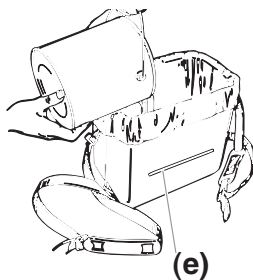

6. Place lid on container and press firmly into place. Secure with the tabs (f).

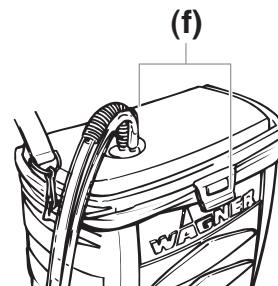

7. Back pack can either be back- or shoulder-mounted as shown. Adjust straps to fit user.



# Speed Control / Flow Control Knob

## Speed Control:

Your sprayer offers you four speed levels (1 being lowest, 4 being highest). The lower the speed level, the closer you can get to your work and the less overspray you will have.

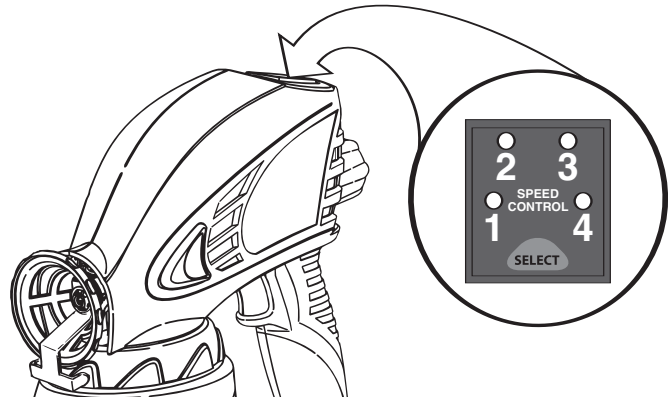

Lower speed levels give you greater control but require more time to cover an area. Depending upon the thickness of the material or conditions, the settings may need to be adjusted. Refer to the chart on the right.

To adjust the speed setting, press the button on the speed control until the light indicates your desired speed.

Speed	Recommended distance from spray object	Flow control knob
1	4 - 8 inches	Low to medium flow
2	6 - 10 inches	Medium flow
3	8 - 12 inches	Medium flow
4	12 inches	Medium to maximum flow

**NOTE - Do not get the speed control wet or the sprayer could be damaged. Be careful during use and cleanup.**

## Flow Control Knob:

The spray pattern is controlled by the Flow Control Knob on the rear of the sprayer, and by the thickness of the material being sprayed.

Turning the flow knob **COUNTERCLOCKWISE** increases the amount of material flow. Turning the flow knob **CLOCKWISE** decreases the amount of material flow.

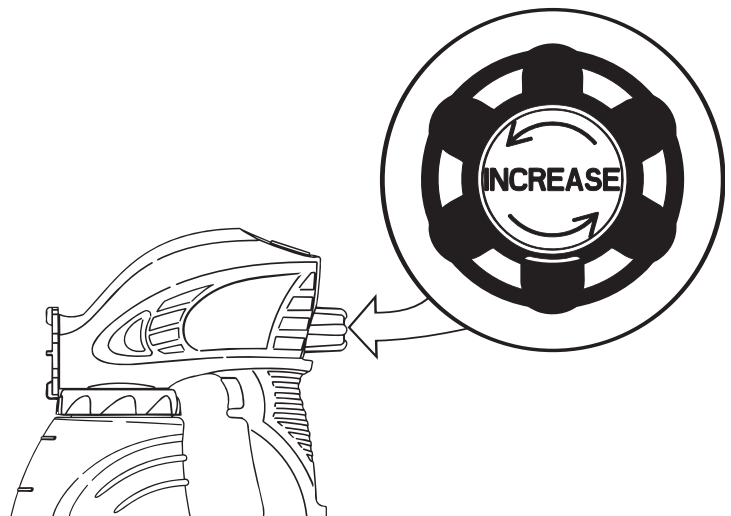



# Testing the Spray Pattern

The instructions below will tell you how to achieve the optimum spray pattern by using each of the features illustrated on the previous page.

1. Turn the flow knob fully **counterclockwise** to maximum and speed control to 4.



2. Point the sprayer at a scrap piece of wood or cardboard, and pull the trigger to prime the sprayer. Release trigger when material sprays evenly from the spray gun.

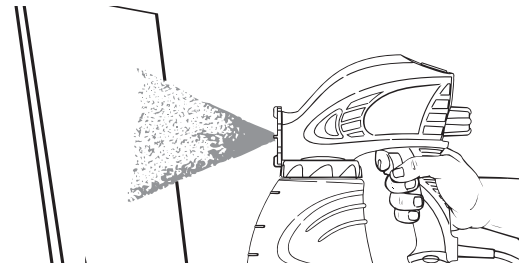

3. To adjust for your particular spray project, press the switch on the top of the gun until the sprayer is set at the desired speed.

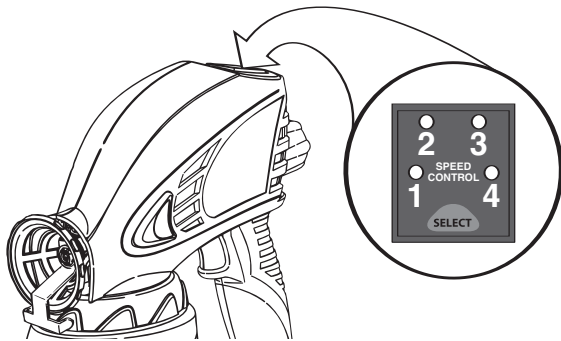

4. Turn the flow knob **clockwise** until you have a good spray pattern.



5. A poor spray pattern **(a)** will concentrate the paint in the center of the spray pattern and go on blotchy. A good spray pattern **(b)** has an even amount of material throughout the pattern and will go on smoothly.

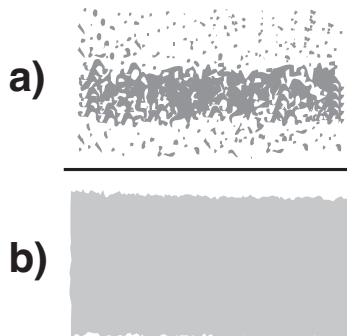

- Always practice spraying on a piece of scrap wood or cardboard to test your spray pattern.
- If you adjust the flow knob and still cannot get a good pattern, you may need to thin the material you are using. Always test spraying without thinning the material. Thin as required to achieve optimum spraying performance (refer to #5).
- If you are spraying a material that needs to be thinned, make sure to follow the manufacturer's recommendations.

# Priming with the Suction Extension

- The time needed to prime will vary from 30 seconds to 3 minutes depending upon the thickness of the material you are spraying.
- If your sprayer is properly cleaned and oiled and it takes longer than three minutes to prime, your piston and/or pump housing may be worn and will need to be replaced before using your suction set.
- Using the suction extension will decrease the material flow, so it will take longer to apply the same amount of material to the surface being sprayed.

1. If you are using the suction extension, you will need to prime the sprayer by removing air from the system. To prime:

Make sure the sprayer is plugged in, and turn the flow control knob counterclockwise to maximum.



2. Hold the sprayer below the level of the paint. This will speed up the priming.

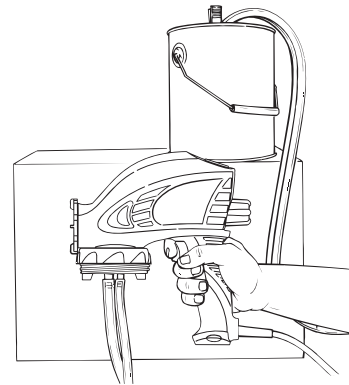

3. Aim the sprayer at a piece of scrap wood or cardboard. Squeeze the trigger and hold until all air is out of the system and material is flowing freely out of the sprayer tip. This could take up to three minutes.

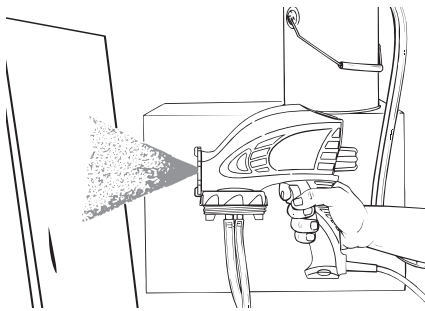

**NOTE - The suction set must remain completely submerged in the material. If it is not completely submerged and air is sucked into the system, the piston could seize. If the piston seizes, the sound the gun makes will change to a low hum and the gun will quickly become hot to the touch. Never run the sprayer when the piston is seized. Should this happen, clean the piston and the pump housing thoroughly using the cleanup procedures found in this manual.**

## Overspray

### Important

Some sprayed materials create a cloud of paint. Some of that cloud will spray past your intended object and also bounce off of it. Wind and air currents may cause this cloud to drift onto surfaces not intended to be sprayed. You can control the amount of overspray and bounce-back by adjusting your flow and moving the sprayer closer to the work piece, but always make sure that you have a good spray pattern. Always test your pattern on a scrap piece of wood or cardboard, and make sure that you have drop cloths protecting anything not being sprayed.

**ANYTHING YOU DON'T WANT PAINTED THAT IS IN THE AREA OF YOUR SPRAYING SURFACE SHOULD BE COVERED OR REMOVED.**

# How To Spray

1. Keep your arm moving at constant speed and keep the sprayer at a constant distance from the surface. The sprayer should be triggered at the beginning of the stroke and released at the end of the stroke.

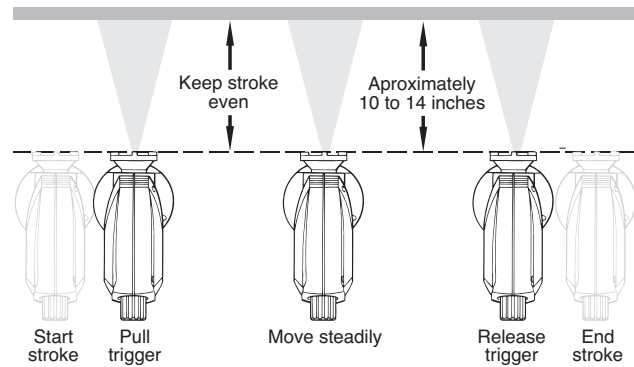

2. Keep the sprayer at right angles to the surface. This means moving your entire arm back and forth rather than just flexing your wrist.



**Never tip the sprayer at more than a 45° angle when spraying overhead. Material could get into the motor housing and cause an electric shock.**

**NOTE - If material is leaking from the threads of the spray tip, turn off the sprayer immediately or the sprayer could be damaged. The sprayer will leak from behind the spray tip if the swirl valve is not seated properly. If you notice material leaking from this area:**

Light Coat Heavy Coat Light Coat

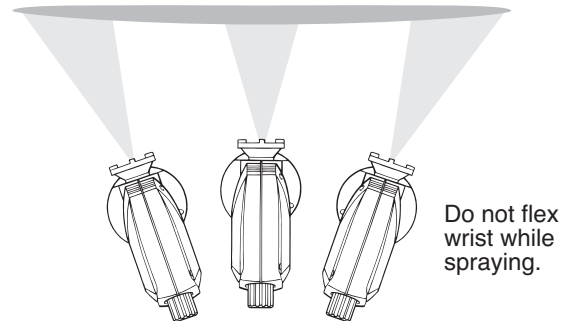

3. **Unplug the sprayer immediately.** Remove the spray tip by turning it **counterclockwise**.

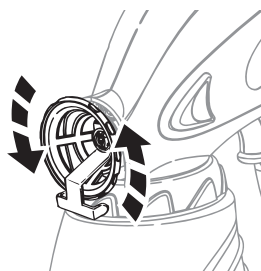

4. Remove the swirl valve and see if it needs to be cleaned or replaced (see page 17). Also check the pump housing opening for any dirt or other obstruction and clean if necessary.

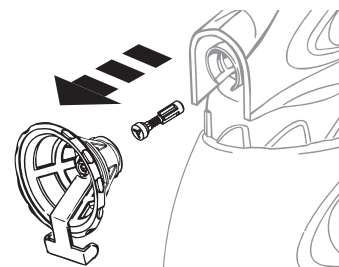

5. Put the swirl valve back in place, making sure it can seat properly without any obstruction.

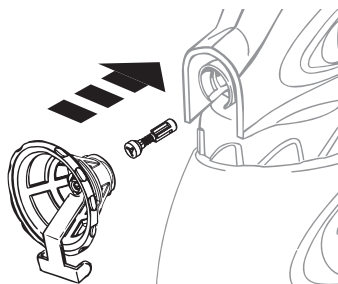

6. Thread on the spray tip by turning it clockwise and tighten firmly by hand.

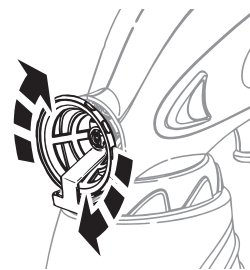

# Using the Quick-clean feature (latex materials only)

## Cleaning the Fluid Container

You will need a garden hose to complete the steps below. If you do not have a garden hose available, or if you used oil-based materials, follow the [Cleanup for Oil-Based Materials](#) instructions on pages 14-15.

1. Unplug the sprayer. Press the Lock-N-Go™ buttons on both sides of the sprayer with one hand, grab the cup with your other hand, and slide the spray cartridge out.

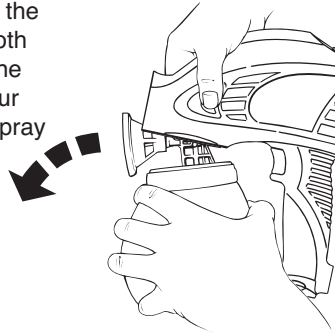

2. Remove container from pump assembly. Pour the remaining material back into the original container. Remove the suction set.



3. Remove all parts from the pump housing assembly. Place all removed parts (except the pump housing assembly) into the fluid container. Fit the quick-clean cap into place on the pump housing ring as shown.

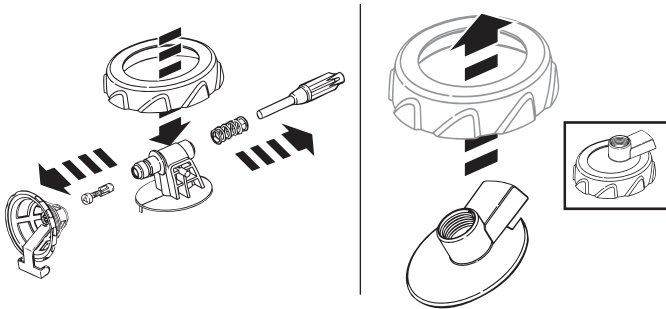

4. Thread the quick-clean cap and ring onto the container. Thread a garden hose into the quick-clean cap, and place entire container and cap into an empty bucket.

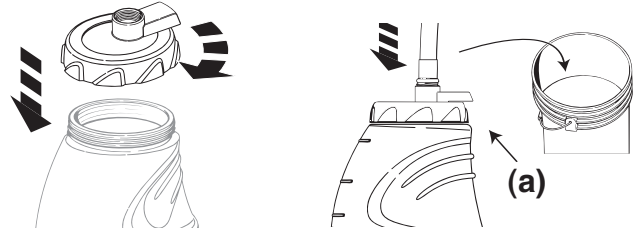

**NOTE** - An empty bucket is needed because water will flow from the side port (a) of the quick-clean cap when the hose is turned on.

5. **SLOWLY** turn the garden hose on. Let the water run for 30 seconds. Turn the water off, remove the garden hose and quick-clean cap from the small container and properly dispose of the cleaning solution.

**BE CAREFUL NOT TO LOSE ANY OF THE PARTS THAT ARE STILL IN THE SMALL CONTAINER!**

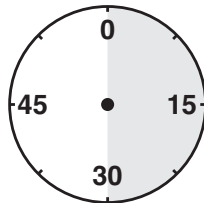

6. Depending upon the thickness of the material, some residue may remain on the sprayer parts. Remove any remaining residue with the cleaning brush and the appropriate cleaning solution.

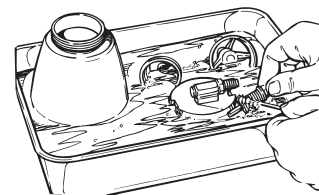

7. **NOTE** - Make sure to completely remove all material from the inside of the piston chamber by scrubbing with the brush. Even a small amount of material can dry like glue and keep the piston from moving, causing damage to the sprayer.

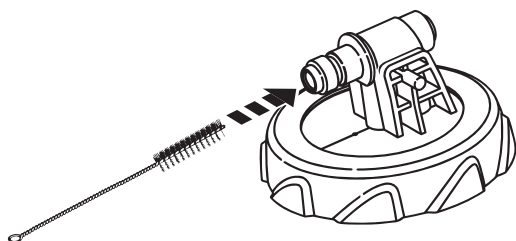

8. **NOTE** - Make sure to keep the vent hole (a) on the pump housing clean and unblocked or a vacuum can build up in the container and cause damage to the sprayer. A toothpick or straightened paper clip can be used to clean it.

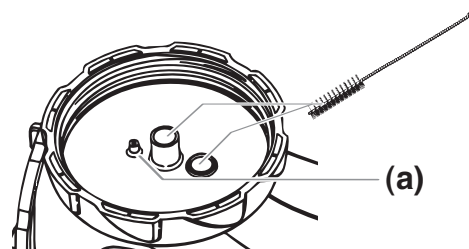

Move on to [Reassembly](#), page 16.

# Using the Quick-clean feature (latex materials only)

## Cleaning the Suction Extension

You will need a garden hose to complete the steps below. If you do not have a garden hose available, or if you used oil-based materials, follow the [Cleanup for Oil-Based Materials](#) instructions on pages 14-15.

1. To purge any remaining material left in the suction hose, remove the suction set from the material container and place into a waste container.

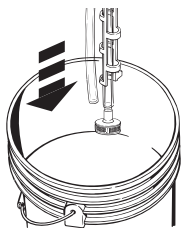

2. Point sprayer into the side of the waste container. Trigger the sprayer until nothing more comes from the spray tip.

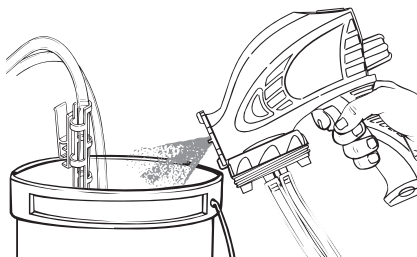

3. Unplug the sprayer. Press the Lock-N-Go™ buttons on both sides of the sprayer with one hand, grab the pump with your other hand, and slide the spray cartridge out.

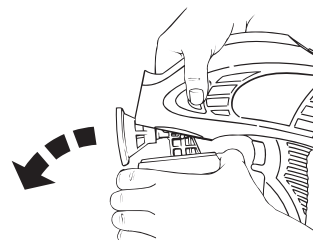

4. Remove piston, spring, spray tip and swirl valve from the pump housing assembly. Place all removed parts into the fluid container.

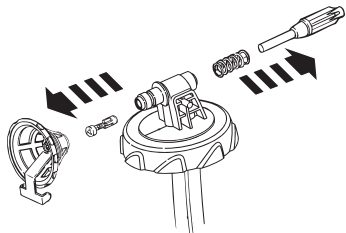

5. Unlock dual hose fitting (with hoses still attached) from pump assembly ring.

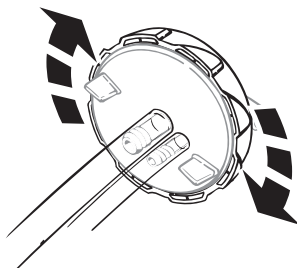

6. Fit the quick-clean cap into place on the pump housing ring as shown.

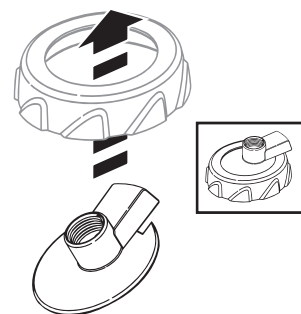

7. Push the dual hose fitting (a) into the intake and return openings on the bottom of the quick-clean cap. The fitting with the ridge (b) goes into the return opening.

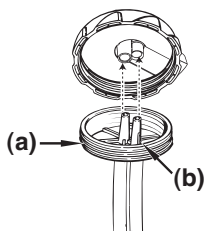

8. Thread a garden hose into the quick-clean cap. Place hoses (with suction set attached) into an empty bucket.

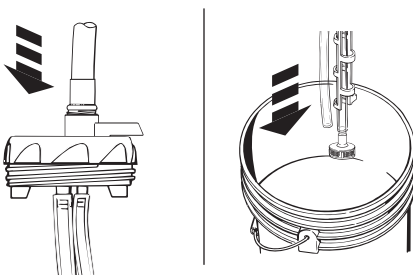

9. **SLOWLY** turn on the garden hose. Let the water run for approximately 30 seconds. Turn the water off.

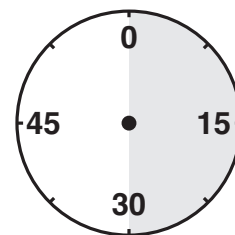

10. Remove the dual hose fitting from the quick-clean cap.

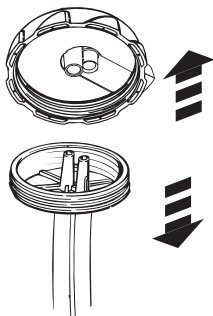

11. Remove the suction set and dual hose fitting from the suction hoses. Place suction set into the fluid container.

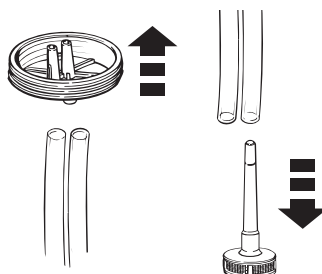

12. Perform steps 4-8 in **Cleaning the Fluid Container** (previous page) in order to clean the components of your sprayer.

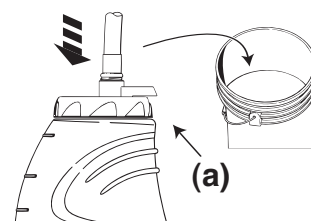

# Cleanup for oil-based materials (fluid container)

1. Unplug the sprayer. Pour the remaining material back into the original container.



2. Fill the container half full of the cleaning solution appropriate to the type of material you sprayed (warm, soapy water for latex materials, mineral spirits for oil-based materials).



3. Reattach the container and plug in the sprayer. Squeeze the trigger until the solution comes through the sprayer for several seconds.

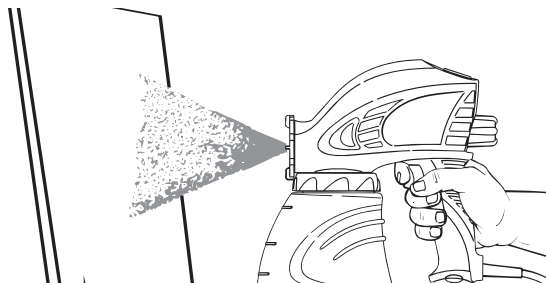

4. Unplug the sprayer. Press the Lock-N-Go™ buttons on both sides of the sprayer with one hand, grab the cup or pump with your other hand, and slide the spray cartridge out.

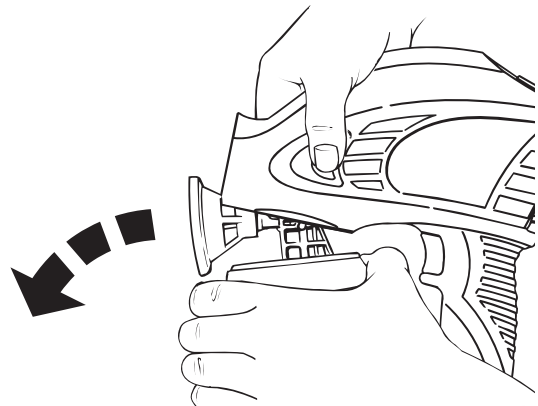

5. Remove the container and properly dispose of the remaining solution.



6. Remove the suction set.

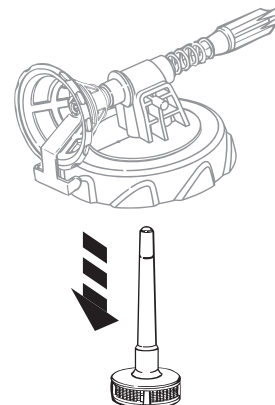

Move on to [Cleaning the Components](#), page 16.



# Cleanup for oil-based materials (suction extension)

1. Make sure the sprayer is unplugged.

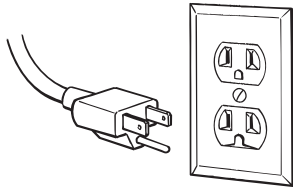

2. Remove the suction set from the material container and submerge into a container of the solvent appropriate to the type of material you sprayed.

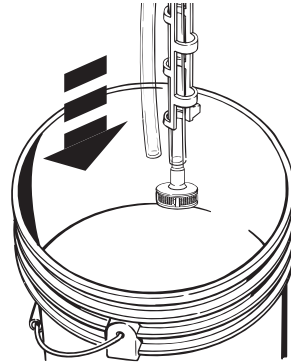

3. Plug in the sprayer, and squeeze the trigger and spray into a second container until the solvent coming through the sprayer is free of material. Unplug the sprayer.

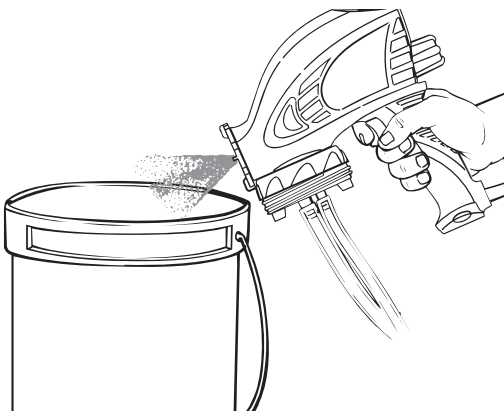

4. Unplug the sprayer. Press the Lock-N-Go™ buttons on both sides of the sprayer with one hand, grab the cup or pump with your other hand, and slide the spray cartridge out.

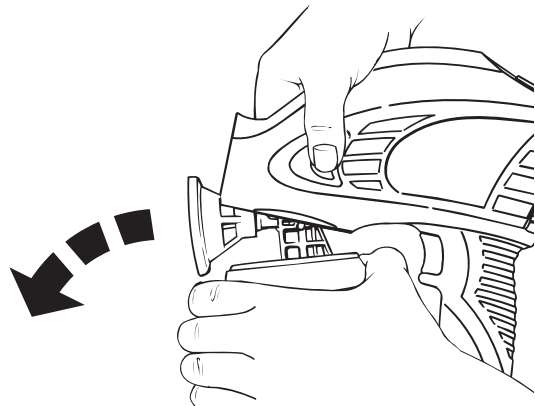

5. Remove the suction set from the cleaning solution. Unlock dual hose fitting (with hoses still attached) from pump assembly ring.

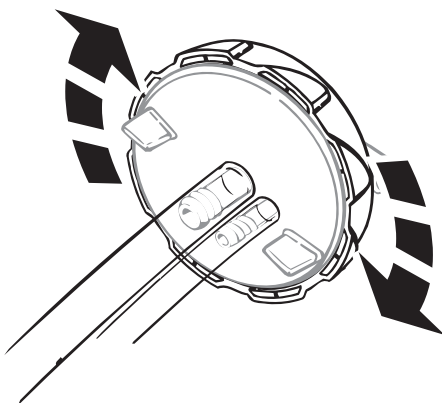

6. Remove the suction set and dual hose fitting from the suction hoses.

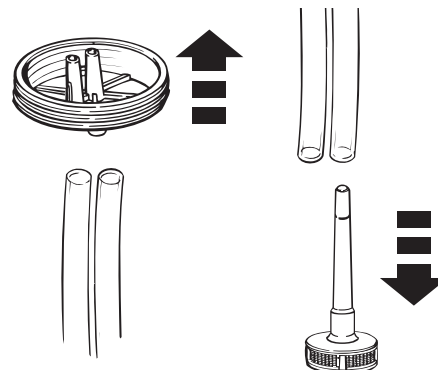

Move on to [Cleaning the Components](#), page 16.

## Cleaning the components (oil-based materials)

1. Remove all parts from the pump housing assembly.

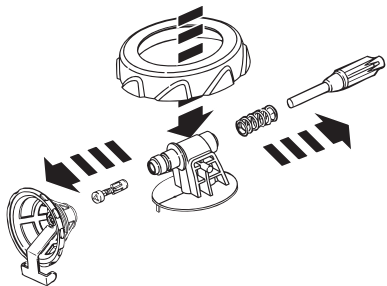

3. Clean all parts thoroughly with the brush provided using a solution appropriate to the type of material you sprayed.

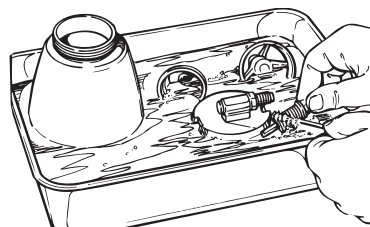

3. **NOTE - Make sure to completely remove all material from the inside of the piston chamber by scrubbing with the brush. Even a small amount of material can dry like glue and keep the piston from moving, causing damage to the sprayer.**

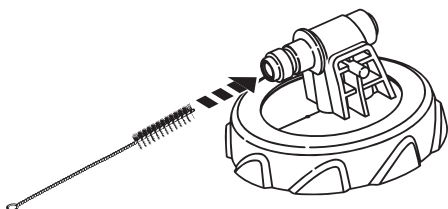

4. **NOTE - Make sure to keep the vent hole (a) on the pump housing clean and unblocked or a vacuum can build up in the container and cause damage to the sprayer. A toothpick or straightened paper clip can be used to clean it.**

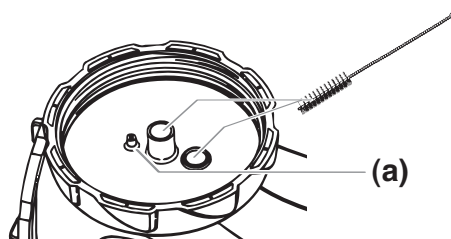

## Reassembly (all materials)

1. Place the pump housing ring over the piston chamber. Slide the spring onto the front end of the piston. Insert the piston into the rear of the piston chamber.
2. Insert swirl valve into front of the piston chamber. Thread the spray tip onto the pump housing.
3. Line up the tab on the pump housing with the notch in the material container. Twist the ring to thread the cup onto the pump.

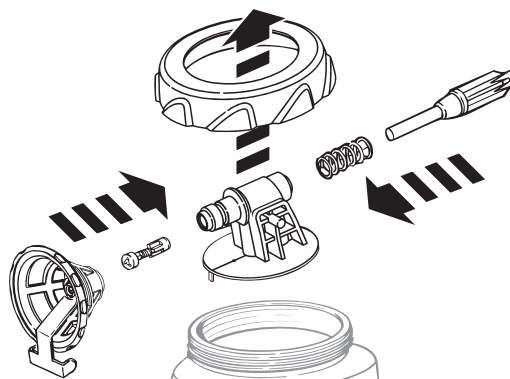

4. Take spray cartridge and slide the rear of the piston into the spray gun. Make sure the pegs (a) on the cartridge line up with the guides (b) at the bottom of the sprayer. Press cartridge up until it locks into place. Pull on the container to make sure assembly is locked into place.

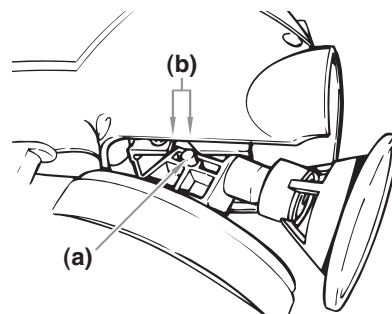
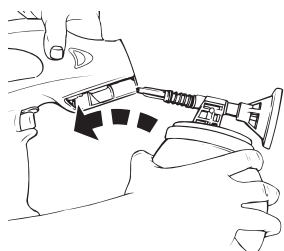

# Maintenance

Lubricating your sprayer prior to storage is important to prolong the life of the pump housing components.

1. Turn the sprayer upside-down while the fluid container is removed. Squeeze a small amount of standard household oil into both the intake (a) and return (b) openings on the pump housing.

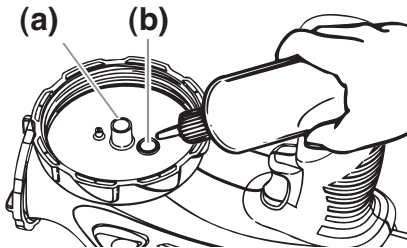

2. Plug in the sprayer. Aim at piece of scrap wood or cardboard and squeeze the trigger of the sprayer for 2 to 3 seconds while sprayer is still inverted.

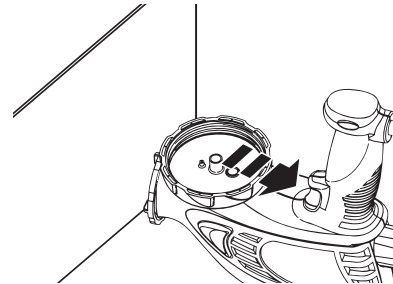

3. Replace the suction set.

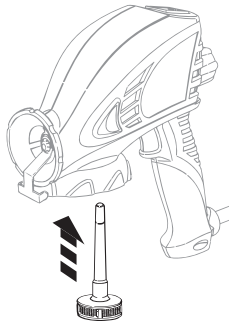

4. Replace the fluid container.

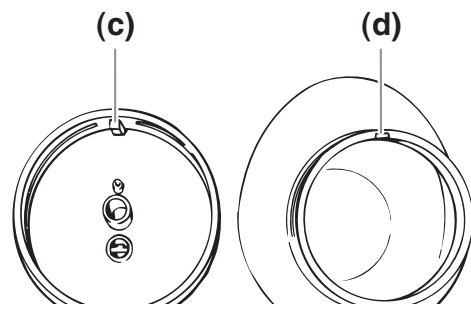

# Replacement Parts

- **Parts of your sprayer wear out with use and require regular replacement. They include the swirl valve, piston and spring. These parts are not covered by your sprayer warranty.**
- **More abrasive materials such as latex paints and stains cause these parts to wear out faster than less abrasive materials such as oil-based paints and stains, thin stains and sealers.**

## Swirl Valve

The swirl valve is shaped to cause the material to spin as it comes out of the sprayer. The spinning breaks the material up into a fine spray. As more material goes through the swirl valve, it wears out the valve and the shape of the valve changes. When it changes too much to produce a good spray pattern, the valve needs to be replaced.

- 1 Front view of a good swirl valve.
- 2 Front view of a swirl valve after spraying 7-10 gallons of latex paint. Replace.
- 3 Front view of a swirl valve after spraying 7-10 gallons of latex stain. Replace.

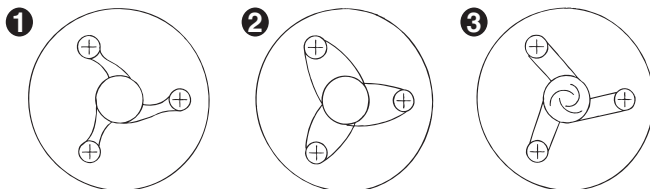

## Piston and Spring

The average life of a piston and spring will vary depending on the types of material being sprayed.

Replace the piston if the sprayer takes longer than 15 seconds with the suction set or 3 minutes with the suction extension to prime when well lubricated, or if there is an excess amount of material leaking, refer to the troubleshooting suggestions listed in this manual. Replace the spring if you notice that it is broken when you clean the sprayer.

**To replace either the swirl valve or the piston and spring, follow steps 1-3 in [Cleaning the Components](#) (page 16), and replace the old parts with new ones. When replaced, follow steps 1-3 in [Reassembly](#) (page 16).**

# Troubleshooting

## Problem

Motor will not run.

## Cause

1. No power at wall outlet. Electrical problem or defective motor.

## Solution

1. Try new wall outlet. Take to Authorized Service Center for repair.

Motor has a low hum and does not spray.

1. Control knob turned in too far.
2. Seized piston.

1. Turn control knob counterclockwise.
2. Disassemble sprayer and clean.

Motor operates properly but does not spray.

1. Failure to prime with 5 ft suction extension.
2. Loose or damaged suction tube.
3. Plugged or worn swirl valve.
4. Swirl valve missing.
5. Material too thick.
6. Plugged spray tip.
7. Intake filter plugged.
8. Control knob needs adjusting.
9. Worn piston.

1. Thin paint. Hold sprayer below level of paint can. Oil intake opening.
2. Tighten or replace.
3. Clean or replace as needed.
4. Put in swirl valve.
5. Thin material.
6. Clean tip.
7. Clean intake filter.
8. Adjust.
9. Clean and oil or replace.

Material spitting or globbing.

1. Low on paint.
2. Paint too thick.
3. Loose suction set drawing in air.
4. Worn swirl valve.
5. Worn spray tip.
6. Control knob needs adjusting.
7. Worn piston.

1. Refill container.
2. Thin paint.
3. Clean and insert firmly in intake opening on pump housing.
4. Replace swirl valve.
5. Replace if worn.
6. Adjust.
7. Replace or clean and oil.

Excessive fogging.

1. Pressure too high.
2. Holding sprayer too far from work surface.

1. Turn flow control knob **clockwise** to reduce pressure and flow.
2. Hold sprayer closer to work surface.

Runs and sags in paint.

1. Arm movement too slow, holding spray gun too close to work surface or applying too much paint at one time.

1. See section on spraying ([page 11](#)).

Material drips from spray tip guard.

1. Guard is for safety and cannot be removed. Some dripping is unavoidable with some paints.

1. Use a small brush on drips that fall on surface being sprayed. Use a drop cloth.

No display on power module

1. No power.
2. Module defective.

1. Check to see if plugged in.
2. Take to Authorized Service Center for repair.

Spraying erratic, module won't adjust

1. Module defective.

1. Take to Authorized Service Center for repair.

Motor overheats.

1. Seized piston.
2. Extension cord too long.
3. Operating continuously.

1. Clean piston.
2. Replace with proper size.
3. Release trigger at end of pass, allow to cool

Material leaking from between spray tip and locking nut.

1. Spray tip is loose.
2. Swirl valve not positioned properly.
3. Worn swirl valve.
4. Eroded pump housing

1. Tighten securely.
2. Unplug the sprayer, remove the spray tip and reposition the swirl valve.
3. Replace.
4. Replace pump housing

Spray cartridge will not lock into place.

1. Piston seized.
2. Locking mechanism defective.

1. Clean entire pump assembly thoroughly.
2. Take to Authorized Service Center for repair.

**▲ WARNING - Any attempt to open the motor housing or repair any electrical parts within the unit by anyone other than an authorized repair technician could cause serious injury and will void the warranty.**

## Additional Repairs

If you have any problems that are not solved by the troubleshooting section of this manual, please call Wagner Technical Service at 1-800-328-8251 Monday through Friday between 8:00 AM and 4:30 PM Central time. If you suspect that you have a problem with the electrical system, or have any other problems not solved by the routine maintenance described in this manual, take your sprayer to the nearest authorized service center.

## Product Registration Card

Send in your product registration card or register online at [www.wagnerspraytech.com](http://www.wagnerspraytech.com). Proper registration will serve as proof of purchase in the event your original receipt becomes misplaced or lost. Returning this card will expedite the processing of your warranty. Be sure you write your unit's **date code** on the card before sending it. The date code is located at the base of the handle (for example, **T087R**). The additional information will also help us to develop new products that best meet your needs and desires.

# Parts list • Liste de pièces • Lista de piezas

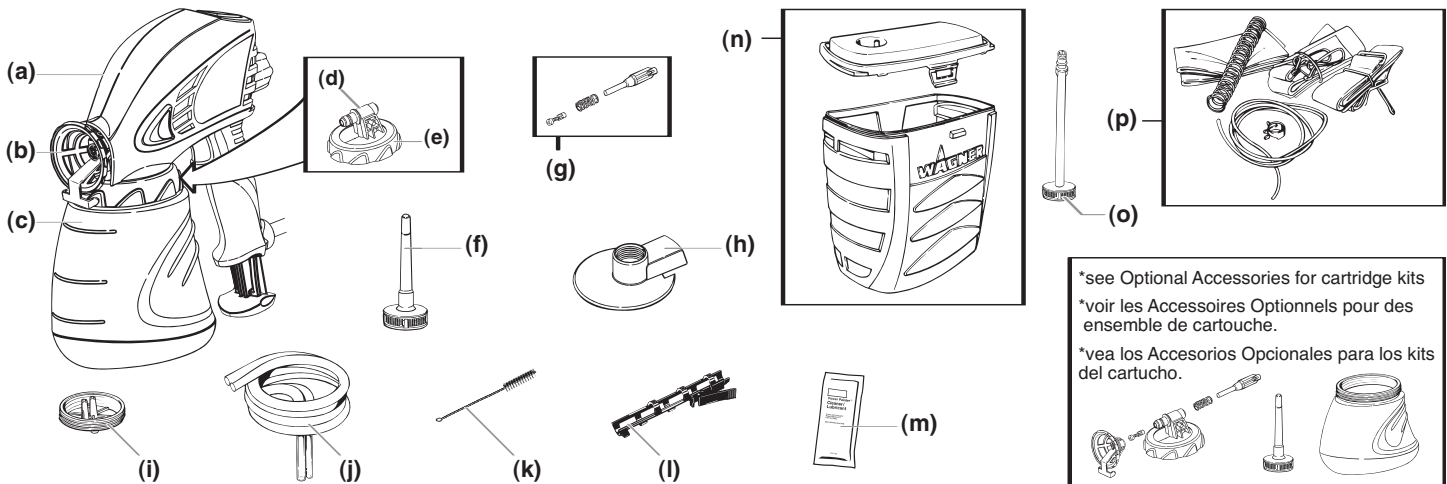

Item Article Artículo	Part No. N° de pièce Pieza No.	English - Description	Français - Description	Español - Descripción	Quantity Quantite Cantidad
a)	-----	Sprayer assembly	Pulvérisateur	Rociador	1
b)	0518236	Wide Shot™ Spray tip	Embout à pulvériser de Wide Shot™	Punta de Wide Shot™	1
c)	0518231	1 1/2 quart container	Réservoir de liquide de 1,42 l (48 oz)	Contenedor de 1 1/2 cuarto de galón	1
d)	0518201	Pump housing	Corps de pompe	Caja de la bomba	1
e)	0518382	Pump housing ring	Anneau du corps de pompe	Anillo de la caja de la bomba	1
f)	0518235	Suction set	Dispositif d'aspiration	Unidad de succión	1
g)	0272909	Piston repair kit	Trousse de réparation de piston	Juego de la reparación del émbolo	1
h)	0518428	Quick-clean cap	Capuchon de nettoyage rapide	Tapa de limpieza rápida	1
i)	0518307	Dual hose fitting	Raccord pour tuyau souple double	Conexión de dos mangueras	1
j)	0518361	Dual hose set	Tuyau souple double	Conjunto de dos mangueras	1
k)	0514209	Cleaning brush	Brosse de nettoyage	Cepillo de limpieza	1
l)	0280353	Container clip	Pince pour contenant	Gancho del envase	1
m)	0280113	Cleaner / lubricant*	Trousse de produits nettoyants/lubrifiants*	Paquete de limpiador y lubricante*	1
n)	0518243	Backpack assembly	Ensemble à dos	Conjunto de mochila	1
o)	0518448	Suction tube (backpack)	Tube d'aspiration (dos)	Tube de succión (mochila)	1
p)	0518225	Strap kit	Ensemble de courroies	Kit de correas	1

\*available in some models

\*disponible dans quelques modèles

\*disponible en algunos modelos

## Optional Accessories • Accessoires Optional • Accesorios Opcional

Part No. N° de pièce Pieza No.	English - Description	Français - Description	Español - Descripción
0272117	Lacquer swirl valve	Soupape rotative pour produits de laques	Válvula en espiral para lacas
0272904	Replacement swirl valves (2)	Soupapes rotative de remplacement (2)	Válvula en espiral de repuesto (2)
0280113	Cleaner / Lubricant	Trousse de produits nettoyants/lubrifiants	Paquete de limpiador y lubricante
0272909	Piston repair kit	Trousse de réparation de piston	Juego de la reparación del émbolo
0272912G	Wide Shot™ spray tip	Embout à Wide Shot™	Punta de Wide Shot™
0280037	Stain tip	Embout de teinture	Punta para tinte
0272900	Round tip (blue)	Buse ronde (bleue)	Punta redonda (azul)
0272902	Round tip (pink)	Buse ronde (rose)	Punta redonda (rosa)
0272903	Round tip (green)	Buse ronde (verte)	Punta redonda (verde)
0518119	Six foot suction set	Tube d'aspiration de 2 m	Tube de succión de 6 pies (2 m)
0272130	Back pack liners (5)	Doublures de sac à dos (5)	Cubiertas para mochila (5)
0518112	Wide Shot™ spray cartridge	Cartouche de pulvérisation Wide Shot™	Cartucho de rociado Wide Shot™
0518113	Round tip (pink) spray cartridge	Cartouche de pulvérisation à buse ronde (rose)	Cartucho de rociado para punta redonda (rosa)
0518114	Stain spray cartridge	Cartouche de pulvérisation pour teinture	Cartucho para rociado de tinte



# Warranty • Garantie • Garantía

## WAGNER ONE-YEAR LIMITED WARRANTY - Keep on File

This product, manufactured by Wagner Spray Tech Corporation (Wagner) is warranted against defects in material and workmanship for one year following date of purchase if operated in accordance with Wagner's printed recommendations and instructions. This warranty does not cover damage resulting from improper use, accidents, user's negligence or normal wear. This warranty does not cover any defects or damages caused by service or repair performed by anyone other than a Wagner Authorized Service Center.

ANY IMPLIED WARRANTY OF MERCHANTABILITY OR FITNESS FOR A PARTICULAR PURPOSE IS LIMITED TO ONE YEAR FOLLOWING DATE OF PURCHASE. THIS PRODUCT IS DESIGNED FOR HOME USAGE ONLY. IF USED FOR COMMERCIAL OR RENTAL PURPOSES, THIS WARRANTY APPLIES ONLY FOR 30 DAYS FROM DATE OF PURCHASE. WAGNER SHALL NOT IN ANY EVENT BE LIABLE FOR ANY INCIDENTAL OR CONSEQUENTIAL DAMAGES OF ANY KIND, WHETHER FOR BREACH OF THIS WARRANTY OR ANY OTHER REASON. THIS WARRANTY DOES NOT APPLY TO ACCESSORIES.

If any product is defective in material and/or workmanship during the applicable warranty period, return it with proof of purchase, transportation prepaid, to any Wagner Authorized Service Center. (A listing of Service Center locations is enclosed with this product.) Wagner's Authorized Service Center will either repair or replace the product (at Wagner's option) and return it to you, postage prepaid.

### Spray Tip Lifetime Warranty

The spray tip you have purchased with your Wagner Power Painter is warranted against wear for the life of the Power Painter. The spray tip warranty does not cover damage resulting from improper use, accidents or user's negligence.

If the spray tip fails due to wear, return it, postage prepaid, to Wagner Spray Tech Corporation, Spray Tip Replacement, 1770 Fernbrook Lane, Minneapolis, MN 55447. Please include your name, complete address and telephone number with the spray tip. Allow 6 to 8 weeks for delivery.

SOME STATES DO NOT ALLOW LIMITATIONS ON HOW LONG AN IMPLIED WARRANTY LASTS OR THE EXCLUSION OF INCIDENTAL OR CONSEQUENTIAL DAMAGES, SO THE ABOVE LIMITATION AND EXCLUSION MAY NOT APPLY TO YOU.

THIS WARRANTY GIVES YOU SPECIFIC LEGAL RIGHTS, AND YOU MAY ALSO HAVE OTHER RIGHTS WHICH VARY FROM STATE TO STATE.

## GARANTIE LIMITÉE D'UN AN - À conserver

Ce produit, fabriqué par Wagner Spray Tech Corporation (Wagner), est garanti contre les défauts de matériaux et de fabrication pendant un an suivant la date d'achat, s'il est utilisé conformément aux recommandations et directives imprimées par Wagner. Cette garantie ne couvre pas les dégâts qui résulteraient d'une mauvaise utilisation, les accidents, la négligence de l'utilisateur ou l'usure normale. Cette garantie ne couvre aucun dégât dû des opérations de maintenance effectuées par tout autre qu'un réparateur approuvé par Wagner.

TOUTE GARANTIE IMPLICITE DE QUALITÉ MARCHANDE OU DE CONFORMITÉ À UN USAGE PARTICULIER EST LIMITÉE À UN AN À PARTIR DE LA DATE D'ACHAT. CE PRODUIT N'EST CONÇU QUE POUR UNE UTILISATION PRIVÉE. DANS LE CAS DE LOCATION OU AUTRES APPLICATIONS PROFESSIONNELLES, CETTE GARANTIE SE LIMITE À 30 JOURS À PARTIR DE LA DATE D'ACHAT. WAGNER NE POURRA EN AUCUN CAS ÊTRE TENUE RESPONSABLE DE DOMMAGES-INTÉRÊTS INDIRECTS OU CONSÉCUTIFS, QUE CE SOIT POUR UNE RUPTURE DE CETTE GARANTIE OU TOUTE AUTRE RAISON. CETTE GARANTIE NE S'APPLIQUE PAS AUX ACCESSOIRES

Si un produit est défectueux, au niveau des matériaux ou de la fabrication, au cours de la durée applicable de la garantie, le renvoyer avec une preuve d'achat, port payé, à l'un des centres de service autorisé par Wagner. (Une liste des adresses de ces centres accompagne tous les produits). Le centre de service autorisé réparera ou remplacera le produit (au choix de Wagner) et le renverra, port payé, et utilisateur.

### Garantie à vie de l'embout du pulvérisateur

L'embout livré avec ce produit Wagner est garanti contre l'usure pour toute la durée utile de l'appareil. Cette garantie ne couvre pas les dégâts résultant d'une mauvaise utilisation du produit, d'accidents ou d'une négligence de l'utilisateur.

Si l'embout du pulvérisateur s'use, le renvoyer, port payé, à Wagner Spray Tech Corporation, Spray Tip replacement, 1770 Fernbrook Lane Minneapolis, Minnesota 55447 (USA). Prière de joindre le nom, l'adresse et le numéro de téléphone de l'utilisateur. Compter un délai de livraison de 6 à 8 semaines.

CERTAINS ÉTATS OU PROVINCES NE PERMETTENT PAS LA LIMITATIONS DE LA DURÉE DE LA GARANTIE IMPLICITE OU L'EXCLUSION DES DOMMAGES-INTÉRÊTS INDIRECTS OU ACCESSOIRES, LES RESTRICTIONS APPARAISSANT AUX PRÉSENTES POURRAIT DONC NE PAS S'APPLIQUER À UTILISATEUR.

LA PRÉSENTE GARANTIE CONFÈRE DES DROITS PRÉCIS À UTILISATEUR, MAIS CELUI-CI POURRAIT AVOIR D'AUTRES DROITS EN VERTU DES LÉGISLATIONS LOCALES..

## GARANTÍA LIMITADA POR UN AÑO - Manténgala archivada

Este producto, fabricado por Wagner Spray Tech Corporation (Wagner), está garantizado contra defectos de materiales y de mano de obra por un año a partir de la fecha de compra, si se utiliza de acuerdo con las instrucciones y recomendaciones especificadas por Wagner. Esta garantía no cubre daños producidos por uso indebido, accidentes, negligencia del usuario o desgaste normal del producto. Tampoco cubre defectos o daños producidos por reparaciones o mantenimiento no realizados por un Centro de servicio autorizado de Wagner.

CUALQUIER GARANTÍA IMPLÍCITA DE COMERCIALIZACIÓN O DE BUEN ESTADO PARA PROPÓSITOS ESPECÍFICOS ESTÁ LIMITADA POR UN AÑO A PARTIR DE LA FECHA DE COMPRA. ESTE PRODUCTO SOLO HA SIDO DISEÑADO PARA USO DOMÉSTICO. SI SE LE DA USO PROFESIONAL Y DE RENTA, ESTA GARANTÍA TIENE UNA DURACIÓN DE 30 DÍAS A PARTIR DE LA FECHA DE COMPRA. BAJO NINGUNA CIRCUNSTANCIA WAGNER SE RESPONSABILIZARÁ POR CUALQUIER DAÑO ACCIDENTAL O COMO CONSECUENCIA DEL USO DEL PRODUCTO, YA SEA POR LA VIOLACIÓN DE ESTA GARANTÍA O POR CUALQUIER OTRA RAZÓN. ESTA GARANTÍA NO INCLUYE LOS ACCESORIOS.

Si cualquier producto presentara defectos de materiales y/o de mano de obra durante el período válido, devuélvalo con el recibo de compra y el flete pagado a cualquier Centro de servicio autorizado de Wagner (este producto viene con una lista de los Centros de servicio). El Centro de servicio autorizado de Wagner reparará o reemplazará el producto (de acuerdo a su criterio) y se lo devolverá haciendo uso de los gastos de flete ya pagados.

### Garantía vitalicia de la boquilla rociadora

La boquilla rociadora que usted ha adquirido con su equipo rociador de pintura Wagner está garantizada contra desgaste por el tiempo que dure su rociador. La garantía de la boquilla no cubre daños producidos por uso indebido, accidentes o negligencia del usuario.

Si la boquilla falla, debido a desgaste, devuélvala con franqueo pagado a Wagner Spray Tech Corporation, Spray Tip Replacement, 1770 Fernbrook Lane Minneapolis, Minnesota 55447. Por favor, junto con la boquilla, incluya su nombre, su dirección completa y su número de teléfono. La boquilla se le devolverá en de 6 a 8 semanas.

ALGUNOS ESTADOS NO PERMITEN LIMITACIONES DE TIEMPO A LAS GARANTÍAS IMPLÍCITAS NI TAMPOCO LA EXCLUSIÓN DE DAÑOS ACCIDENTALES O COMO CONSECUENCIA DEL USO DEL PRODUCTO, POR LO QUE ES POSIBLE QUE LA LIMITACIÓN ANTERIOR NO SE APLIQUE A SU CASO PARTICULAR.

ESTA GARANTÍA LE OTORGA CIERTOS DERECHOS LEGALES ESPECÍFICOS Y TAMBIÉN PUEDE ACCEDER A OTROS DERECHOS QUE VARIAN DE UN ESTADO A OTRO.

Wagner Spray Tech Corporation  
1770 Fernbrook Lane  
Plymouth, MN 55447  
Telephone 1-800-328-8251

Copyright © 2006 Wagner Spray Tech Corporation.  
All rights reserved, including right of reproduction in  
whole or in part, in any form.